

Mosaic™ International socket outlets

Cat. No(s): 5 721 12/13/14/21/24/31/32/33/34

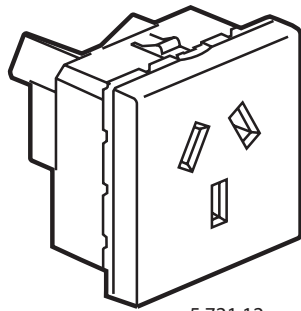

5 721 12

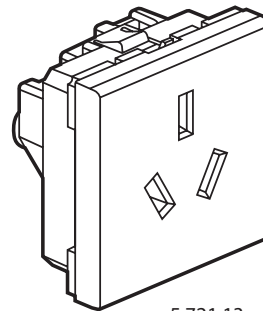



5 721 13

1. USE

Socket outlets for different international standards.

2. RANGE

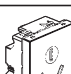
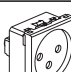
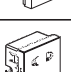
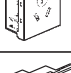
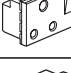
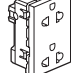
	Designation	Cat. Nos.	Number of modules	Connection method	Weight (g)	Characteristics
	Australian socket 2P+E white	5 721 12	2	with screws	33.3	15 A - 240 VAC
	Chinese socket 2P+E white	5 721 13	2	with screws	36.6	10 A - 250 VAC
	Australian socket 2P+E white	5 721 14	2	with screws	36.2	10 A - 240 VAC
	Chinese socket 2P+E white	5 721 21	2	with screws	45.1	16 A - 250 VAC
	Israeli socket 2P+E white	5 721 24	2	with screws	32.6	16 A - 250 VAC
	Chinese 2P+E + Euro/US socket 2P white	5 721 31	3	with screws	55.4	16 A - 250 VAC 10 A - 250 VAC
	British switched socket 2P+E white	5 721 32	3	with screws	64.4	15/16 A 250 VAC
	Euro/US double socket 2 x 2P+E white	5 721 33	3	with screws	58.2	15 A - 127 VAC 16 A - 250 VAC
	US double socket 2 x 2P+E white	5 721 34	3	with screws	57.5	15 A - 127 VAC

3. PREPARATION

The mechanisms can be flush-mounted or surface-mounted.

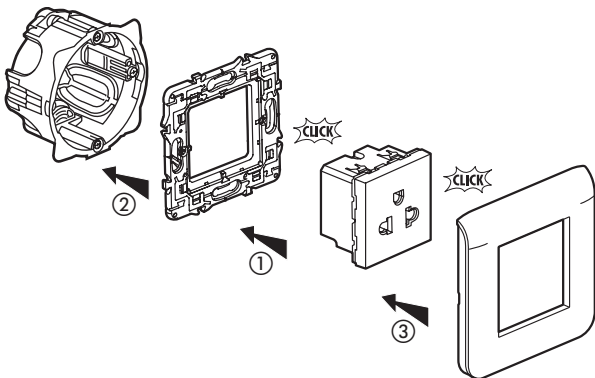

4. OVERALL DIMENSIONS

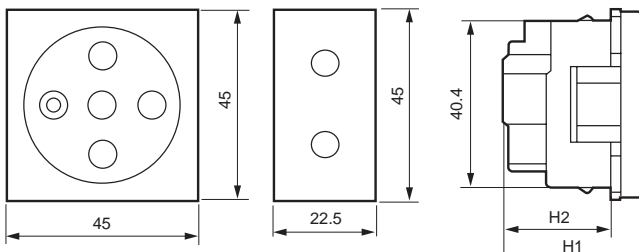

Cat. No.	H1	H2
5 721 12	41	31.5
5 721 13	29.7	21.1
5 721 14	32	23.4
5 721 21	32	23
5 721 24	37	28

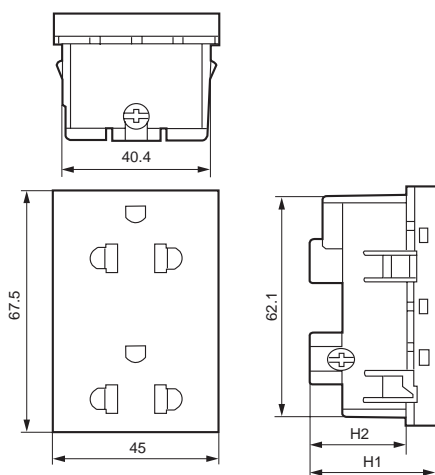

Cat. No.	H1	H2
5 721 31	32.8	24.2
5 721 32	41.5	28.5
5 721 33	35.2	26.7
5 721 34		

5. CONNECTION

Cat. No.	Capacity	Stripping	Screwdriver
5 721 12	2 x 4 mm ²	9 mm	Cross-head 2 or 4 mm flat-blade
5 721 13			4 mm flat-blade
5 721 14		13 mm	Cross-head 2 or 4 mm flat-blade
5 721 21	2 x 4 mm ²	9 mm	4 mm flat-blade
5 721 24	2 x 2.5 mm ²	11 mm	Cross-head 2 or 4 mm flat-blade
5 721 31	2 x 4 mm ²	9 mm	4 mm flat-blade
5 721 32			
5 721 33			Cross-head 2 or 4 mm flat-blade
5 721 34			

6. OPERATION

Standard operation by insertion of withdrawal of a plug to normalized standard.

7. TECHNICAL CHARACTERISTICS

7.1 Mechanical characteristics

Impact tests: IK 04

Protection by solid bodies / liquids: IP 40 (mounted)
IP 20 (alone)

7.2 Material characteristics

Base: Polycarbonate (except 5 721 24: Polypropylene)
Cover plates: Polycarbonate

7.3 Electrical characteristics

Self-extinguishing: 650° C / 30 s

7.4 Climatic characteristics

Storage temperatures: - 10° C to + 70° C
Operating temperatures: - 5° C to + 50° C

8. CLEANING

Surface cleaning with a cloth.

Do not use: acetone, tar remover, trichlorethylene.

Resistance to the following cleaning agents: Hexane (EN-60669-1), Methylated spirits, Soapy water, diluted ammonia, diluted pure bleach 10%, Glass cleaning substance, Pre-impregnated wipes.

Caution: A preliminary test should be carried out if other specific cleaning products are to be used.